

# How to measure your Bridle

1



REMINER  
DOUBLE CHECK  
THE  
MEASUREMENTS  
BEFORE  
CONTACTING  
EB !

## 1. Browband

Measure the browband's total length from one end to the other

2



## 2. Headpiece

From the end of the throatlash one side to the end of the point strap the other side



Is it difficult to get a Bridle to fit your horse? Let us customise one for you - simply follow the 'How to measure your bridle guide'. Then email the measurements to: [info@englishbridles.co.uk](mailto:info@englishbridles.co.uk)

We'll do the rest!

3

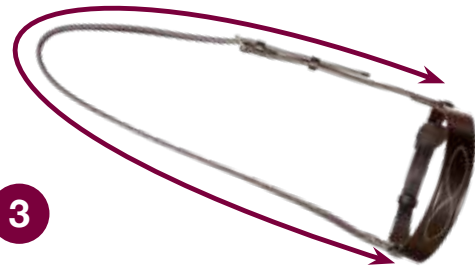

## 3. Noseband Heads Strap

Measure the headstrap from where it joins the noseband one side over the head to where it joins the noseband the other side. Do not include the noseband



## 5. Noseband

Measure the noseband, excluding the buckle, from one end to the hole that you do up on

4



## 4. Bit to Bit

From where the cheekpieces join the bit one side over the head to where the cheekpieces join the bit the other side